

FORM NO 1.

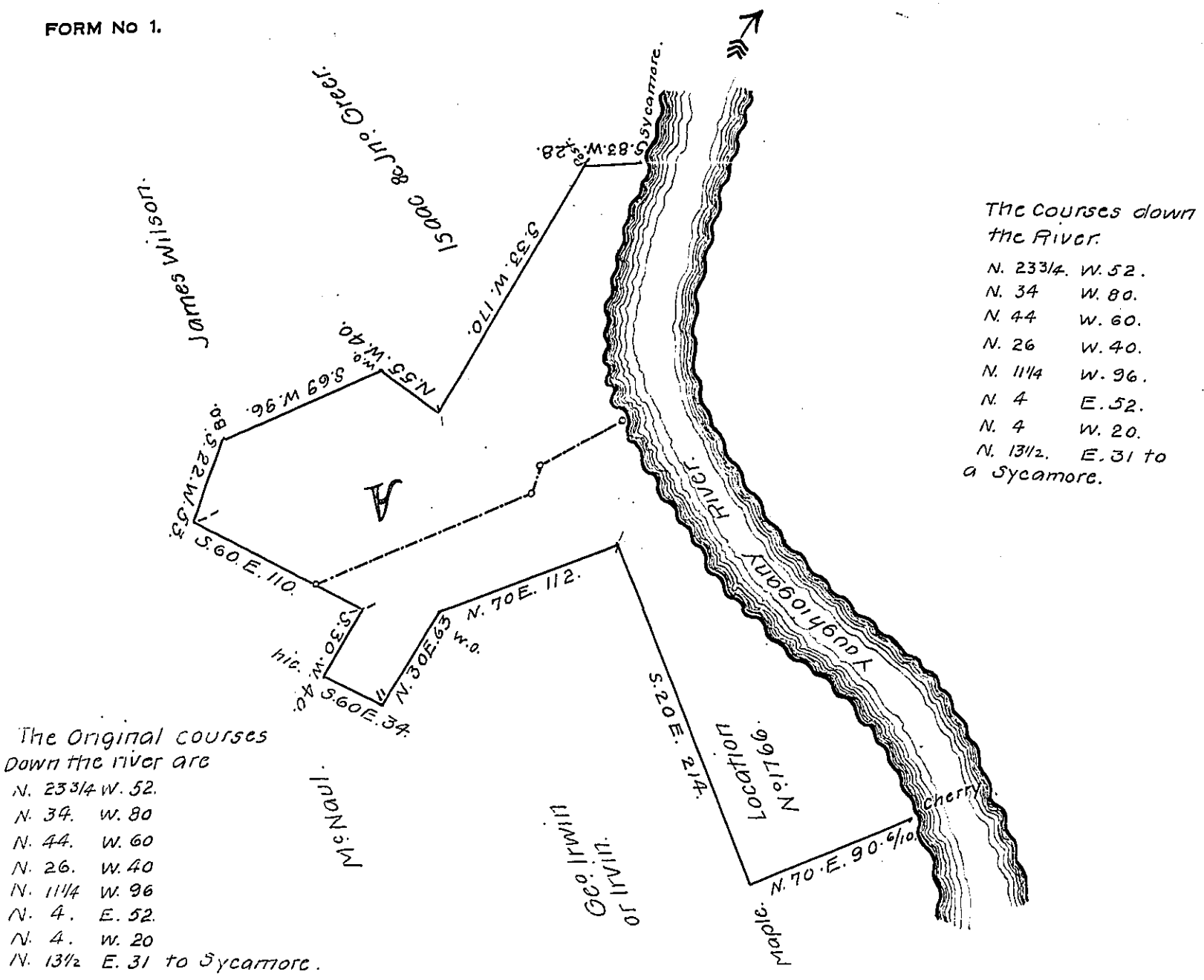

Pursuant to Contract with the Board of Property of the State of Penna dated 1st of Nov^r 1827 and the authority therein, I have attended to the duties Required &c Report the following Notes &c as the result of my Investigations &c

Note: the above Survey was first Executed on Order N^o 1706 to Alex^e Dunlap in right of Jn^o Carothers & upon the Land called for in the Location, The same Tract has since been Surveyed on order N^o 1869 & a patent for part of the said Tract Issued to Thomas Martin.

See letter A which makes a considerable Interference with the original Survey Containing 300 Ac^s &c All^s.

Gab^l Meister Esqr.,
S.G. of Penna.

Rob^t Beatty,-
Nov^r 12th 1828.

IN TESTIMONY that the above is a copy of the original remaining on file in the Department of Internal Affairs of Pennsylvania, made conformably to an Act of Assembly approved the 16th day of February, 1833, I have hereunto set my Hand and caused the Seal of said Department to be affixed at Harrisburg, this twentieth day of October, 1908.

Henry Hoover
Secretary of Internal Affairs.